

Connector	Manufacturer	Part Number	Description	Notes
8 CH DIO Inline	Molex	43025-2000	20way, Female	
Controller - Inputs	Phoenix	1840447	10way, Screw Terminal	39500-5010 is an approved substitute
Controller - Outputs	Phoenix	1840447	10way, Screw Terminal	

REVISIONS			
REV.	DESCRIPTION	DATE	INITIAL
1	Initial Release	7/16/2019	BM
2	Increased base harness length from 250mm to 300mm	7/24/2020	RK
3	Change Inputs & Output Conn lables + dims added	8/14/2020	RK
4	DRAFT Add heat shrink and sleeve dimensions	8/31/2020	KKN

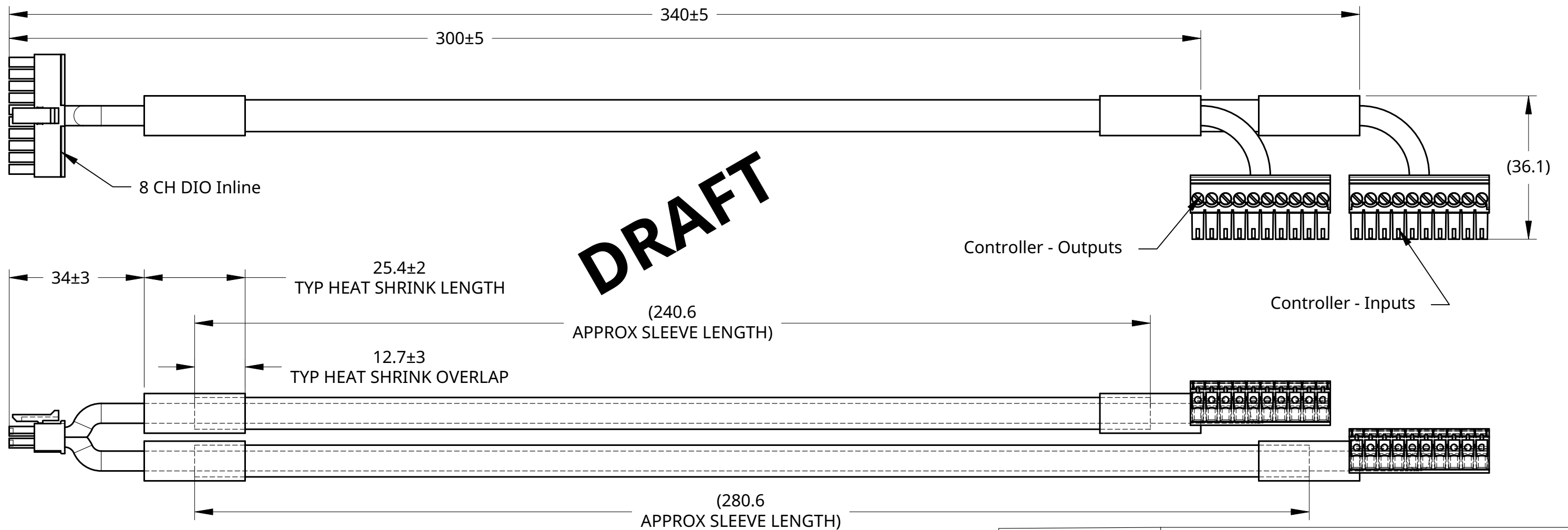

NOTES:

- Use nylon braided covering with heat shrink (1in, 50/50 overlap) on ends for each branch of wires
- Wire Type: TXL (or Pico MES approved alternative)

UNLESS OTHERWISE SPECIFIED, DIMENSIONS ARE IN MILLIMETERS			
DO NOT SCALE DRAWING		Part Name HARNESS, DIO TO IC-PCM	
BREAK ALL SHARP EDGES AND REMOVE BURRS		NAME RYAN KUHLNBECK	DATE 07/16/2019
THIRD ANGLE PROJECTION		SIZE B	
		PART NO. 500001-0-C1	
MATERIAL	FINISH	SCALE 1:1	Mass SHEET 1 of 2

Connector 1	Pin #	Description	Color	Size	Terminal PN	Connector 2	Pin #	Terminal PN	Notes
8 CH DIO Inline	1	Input 1, +24 V to DIO (From TQ Tool Controller)	WHT	22	43030-0001	Controller - Outputs	3	E0308	
8 CH DIO Inline	2	Input 2, +24 V to DIO (From TQ Tool Controller)	PNK	22	43030-0001	Controller - Outputs	4	E0308	
8 CH DIO Inline	3	Input 3, +24 V to DIO (From TQ Tool Controller)	YEL	22	43030-0001	Controller - Outputs	5	E0308	
8 CH DIO Inline	4	Input 4, +24 V to DIO (From TQ Tool Controller)	TAN	22	43030-0001	Controller - Outputs	6	E0308	
8 CH DIO Inline	5	Input 5, +24 V to DIO (From TQ Tool Controller)	ORG	22	43030-0001	Controller - Outputs	7	E0308	
8 CH DIO Inline	6	Input 6, +24 V to DIO (From TQ Tool Controller)	GRN	22	43030-0001	Controller - Outputs	8	E0308	
8 CH DIO Inline	7	Input 7, +24 V to DIO (From TQ Tool Controller)	BLU	22	43030-0001	Controller - Outputs	9	E0308	
8 CH DIO Inline	8	Input 8, +24 V to DIO (From TQ Tool Controller)	PPL	22	43030-0001	Controller - Outputs	10	E0308	
8 CH DIO Inline	9	24V Supply to DIO (From TQ Tool Controller)	RED	22	43030-0001	Controller - Outputs	1	E0308	Pins 9 & 10 are tied together internally in DIO
8 CH DIO Inline	10	Not Populated - Spare 24V Supply							Pins 9 & 10 are tied together internally in DIO
8 CH DIO Inline	11	Output 1, +24V to TQ Tool Controller (From DIO)	WHT/BLK	22	43030-0001	Controller - Inputs	3	E0308	
8 CH DIO Inline	12	Output 2, +24V to TQ Tool Controller (From DIO)	PNK/BLK	22	43030-0001	Controller - Inputs	4	E0308	
8 CH DIO Inline	13	Output 3, +24V to TQ Tool Controller (From DIO)	YEL/BLK	22	43030-0001	Controller - Inputs	5	E0308	
8 CH DIO Inline	14	Output 4, +24V to TQ Tool Controller (From DIO)	TAN/BLK	22	43030-0001	Controller - Inputs	6	E0308	
8 CH DIO Inline	15	Output 5, +24V to TQ Tool Controller (From DIO)	ORG/BLK	22	43030-0001	Controller - Inputs	7	E0308	
8 CH DIO Inline	16	Output 6, +24V to TQ Tool Controller (From DIO)	GRN/BLK	22	43030-0001	Controller - Inputs	8	E0308	
8 CH DIO Inline	17	Output 7, +24V to TQ Tool Controller (From DIO)	BLU/WHT	22	43030-0001	Controller - Inputs	9	E0308	
8 CH DIO Inline	18	Output 8, +24V to TQ Tool Controller (From DIO)	PPL/WHT	22	43030-0001	Controller - Inputs	10	E0308	
8 CH DIO Inline	19	Ground Reference (From TQ Torque Controller)	BLK	22	43030-0001	Controller - Outputs	2	E0308	
8 CH DIO Inline	20	Ground Reference (From TQ Torque Controller)	BLK/WHT	22	43030-0001	Controller - Inputs	2	E0308	

RYAN KUHLNBECK

NOTES:

- Substitutions are allowed for the E0308 Ferrule Upon approval by Pico MES
- Loose equivalent to Molex 43031-0001 (reel) is 43030-0007
- Wire type: TXL (or Pico MES approved alternative)

UNLESS OTHERWISE SPECIFIED,
DIMENSIONS ARE IN MILLIMETERS



DO NOT SCALE DRAWING

BREAK ALL SHARP EDGES AND
REMOVE BURRS

THIRD ANGLE PROJECTION

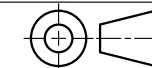

MATERIAL

Part Name

HARNESS, DIO TO IC-PCM

NAME

RYAN KUHLNBECK

DATE

07/16/2019

SIZE

B

PART NO.

500001-0-C1

FINISH

SCALE

Mass

SHEET 2 of 2